

COLD START KIT

UPS model: M2X - MP2 300

Installation manual

INTRODUCTION

Thank you for choosing our product.

Our company is specialized in the development and production of uninterruptible power supplies (UPS).

The device described in this manual is a high-quality product that has been carefully designed and manufactured to guarantee optimal performance.

This manual contains detailed instructions for product use and installation.

For information about using and to get the maximum performance from your UPS, this manual should be carefully kept near the UPS and READ IT BEFORE ANY OPERATION ON IT.

NOTE: Some of the images in this document are provided as a guideline only, and they may not accurately reproduce the depicted product components.

ENVIRONMENTAL PROTECTION

Our company devotes abundant resources to analyzing environmental aspects in the development of its products. All our products pursue the objectives defined in the environmental management system developed by the company in compliance with applicable standards.

Hazardous materials such as CFCs, HCFCs or asbestos have not been used in this product.

When evaluating packaging, the choice of material has been made favoring recyclable materials.

Please separate the different material of which the packaging is made and dispose of all material in compliance with applicable standards in the country in which the product is used.

DISPOSING OF THE PRODUCT

The Cold Start Kit contains internal materials which are considered TOXIC, such as electronic circuit boards. Treat these materials according to the laws in force, contacting qualified centers.

Proper disposal contributes to respect for the environment and human health.

SAFETY



Read the "SAFETY MANUAL" before starting any installation operations.

All the operations described in this manual must be performed by qualified and trained personnel only.



The device must be used exclusively for the purpose for which it was designed. Any other use is to be considered improper and as such dangerous. The manufacturer declines all responsibility for damage caused by improper, wrong and unreasonable use.

COLD START

The Cold Start is a function that allows the system to start from the batteries, with the mains disconnected. This manual contains detailed instructions to install the board that allows the cold start function: Cold Start Unit.

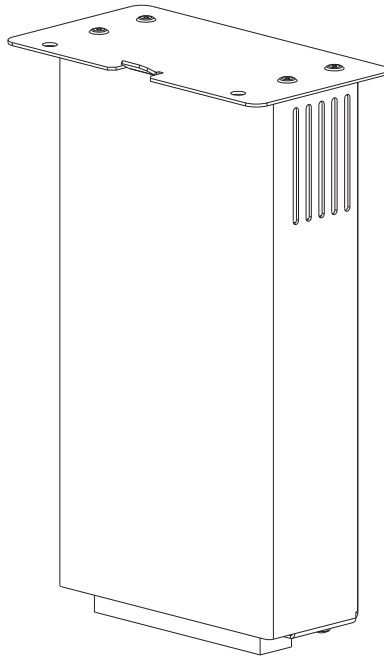

Cold Start Unit

COLD START UNIT INSTALLATION



The following operations must only be performed by skilled and specifically trained personnel.

When the Cold Start Unit is not inserted, uncovered parts with dangerous voltage are present on the corresponding backplane.



Remove the Cold Start Unit only in case of maintenance or replacement.

Strictly comply with the instructions listed below.



***SAVE THIS INSTRUCTIONS:** This manual contains important instructions to properly install the Cold Start unit.*

Read manual before starting Cold Start unit installation.

INSERTION

1. Remove the protection cover (see figure beside) to make accessible the Cold Start button and panel mount fuses.

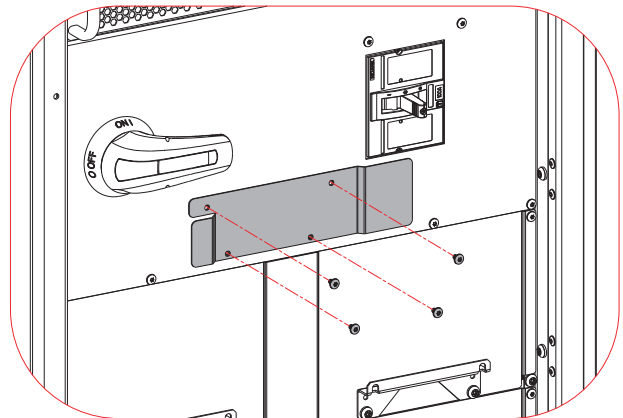

WARNING: *It is mandatory to remove the panel mount fuses before make the operations*

2. Remove the panel mount fuses positioned behind the cover.

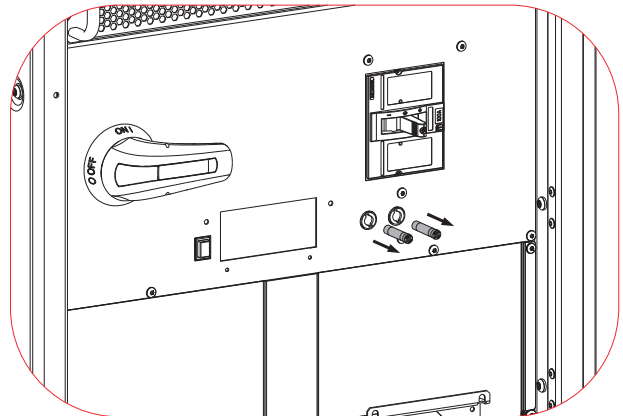

3. Carefully insert the Cold Start Unit into the slot and fix it by using the screws previously removed.

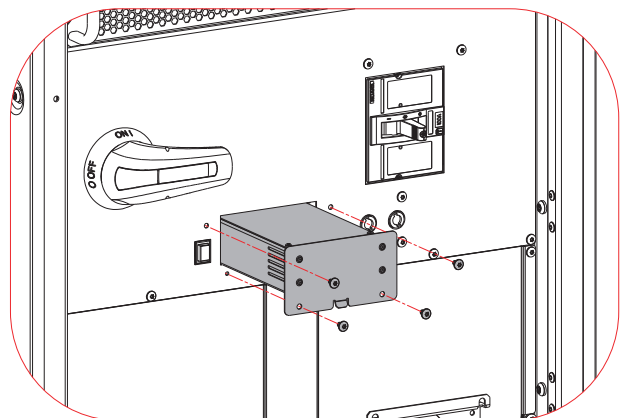

4. Reinsert the panel mount fuses.

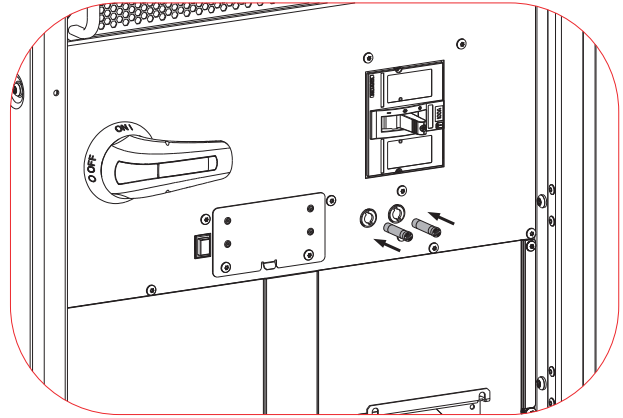

EXTRACTION

To extract the Cold Start Unit, reverse the procedure described above. In short:

1. Remove the panel mount fuses.
2. Remove the fastening screws and store them.
3. Carefully remove the Cold Start Unit from its housing.
4. In the case of a new Cold Start Unit is not immediately inserted, reinsert the panel mount fuses and install the supplied protection cover by using the screws previously removed.
5. Reinsert the panel mount fuses.

COLD START PROCEDURE

1. Close the battery switch.
2. Press the “Cold start” button and keep it pressed for at least 5 seconds.
3. The system will turn on in the “STAND-BY WITH CB OFF” mode (The status led will light up and the display will start).
NOTE: if no actions are taken within one minute, the system will automatically shut down to avoid discharging the batteries.
4. Verify that no anomalies are present on the status bar (except for the anomalies/faults “PM/PMs fault/lock or PM/PMs anomaly”, “Bypass not available”, “Bypass volt. out of range”, “Inverter asynchronous”)
5. From the “Command Panel” page, press the “System: ON/OFF” from “O” to “I”.

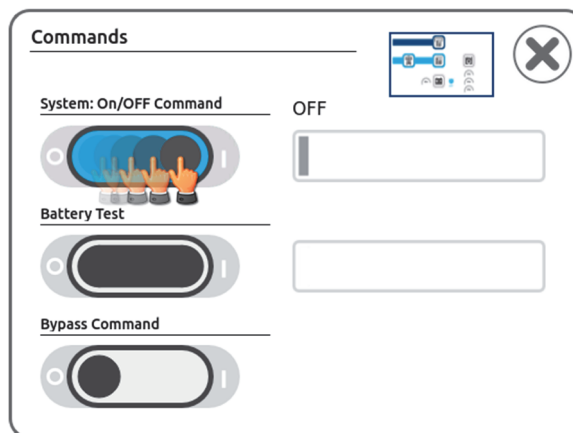

6. Confirm the “SYSTEM ON Command”. The UPS will turn on.
7. Verify the output voltages on the Output status page.
8. The system is now in the BATTERY WORKING mode.
9. To restore the UPS to ON LINE mode, the mains voltage must be present. The UPS will change to ON LINE mode and the batteries will start charging.